

	Scanning distance 10 ... 50 mm
Luminescence scanners	

- UV semi-conductor light source
- No lamp replacement
- Scanning distance selectable by using interchangeable lenses

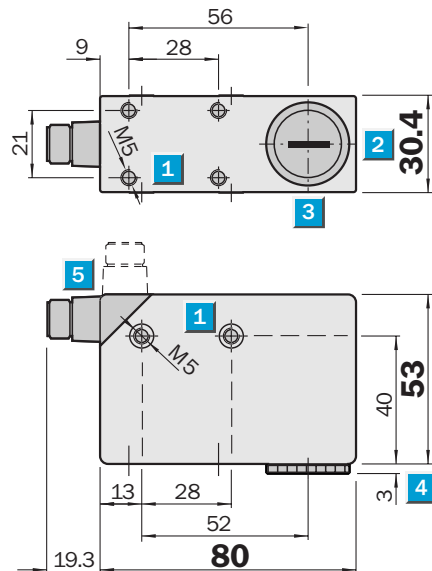

Dimensional drawing



LUT 3-610

LUT 3-650

LUT 3-620

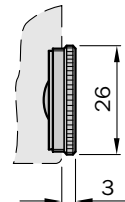
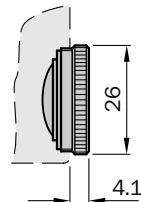

Adjustments possible

All types

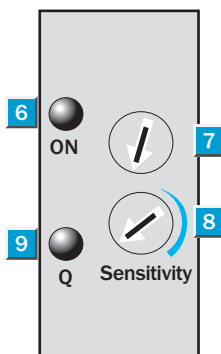

- 1 M5 threaded mounting hole, 5.5 mm deep
- 2 Light spot direction
- 3 Centre of optical axis
- 4 See dimensional drawing for lens
- 5 M12 plug (rotatable)
- 6 Operating indicator
- 7 Not used
- 8 Sensitivity adjustment
- 9 Output indicator

Connection type

All types

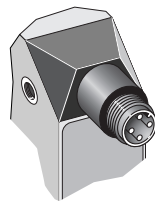

4-pin, M12

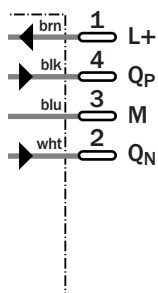

See chapter Accessories

Connectors

Mounting systems

Lenses

Technical data		LUT3-	610	620	650							
Scanning distance¹⁾/light spot sizes	10 mm/Ø 2 x 6 mm											
	20 mm/Ø 3 x 9 mm											
	50 mm/Ø 5 x 15 mm											
Light spot direction	Longitudinal											
Light source²⁾, light type	UV light source											
Wavelength	385 nm											
Supply voltage V_S	12 ... 30 V DC ³⁾											
Ripple ⁴⁾	max. 2 V											
Current consumption ⁵⁾	60 mA											
Switching outputs	Light-switching											
	PNP: HIGH = $V_S - <3$ V / LOW = 0 V											
	NPN: HIGH = V_S / LOW = <2 V											
Output current I_A max.	100 mA											
Response time ⁶⁾	0.3 ms											
Switching frequency ⁷⁾	1.5 kHz											
Connection type	Plug											
VDE protection class⁸⁾	□											
Circuit protection⁹⁾	A, B, C											
Enclosure rating	IP 67											
Ambient temperature T_A	Operation -10 °C ... +55 °C											
	Storage -25 °C ... +75 °C											
Shock load	To IEC 68											
Weight	400 g											
Housing material	Die-cast metal											

¹⁾ From front edge of lens

²⁾ Average service life 100,000 h at $T_A = +25$ °C

³⁾ Limit values

⁴⁾ May not exceed or fall short of V_S tolerances

⁵⁾ Without load

⁶⁾ Signal transit time with resistive load

⁷⁾ With light/dark ratio 1:1

⁸⁾ Reference voltage 50 V DC

⁹⁾ A = V_S connections reverse-polarity protected

B = Outputs Q_P und Q_N short-circuit protected

C = Interference pulse suppression

Scanning distance

- 1 Scanning distance 10 mm
- 2 Scanning distance 20 mm
- 3 Scanning distance 50 mm

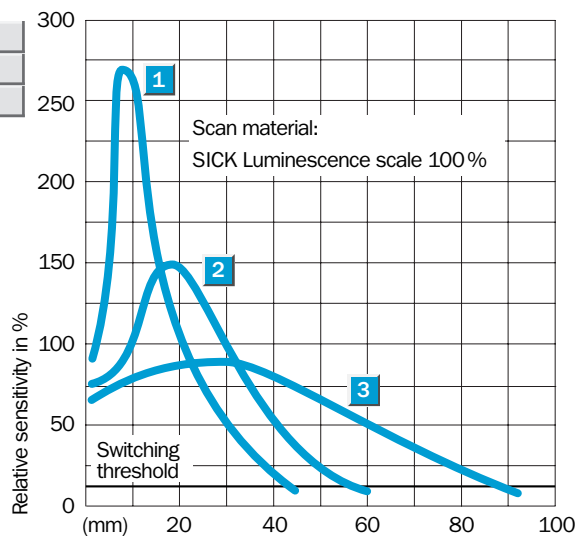

Order information

Type	Order no.
LUT3-610	1 015 396
LUT3-620	1 015 397
LUT3-650	1 015 398

LUT3-6 is not supplied with additional filter or fibre-optic cable

OBJ-LUT3-10	2 016 348
OBJ-LUT3-20	2 016 349
OBJ-LUT3-50	2 016 350

	Scanning distance 10 ... 90 mm
Luminescence scanners	

- UV semi-conductor light source
- No lamp replacement
- Scanning distance selectable by using interchangeable lenses
- Fibre-optic cable connection
- Analogue output
- Additional optical filter



Dimensional drawing

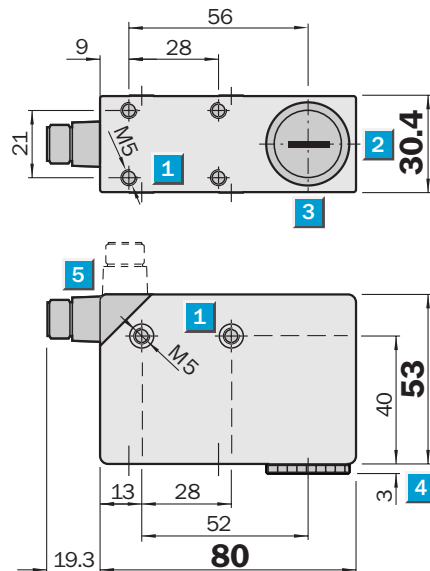

LUT3-810

LUT3-820

LUT3-850

LUT3-851

LUT3-852

LUT3-853

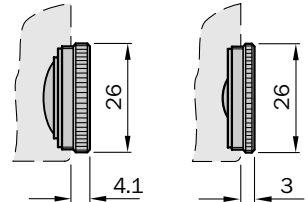

LUT3-890

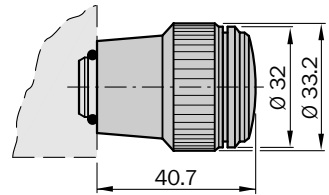

Adjustments possible

All types

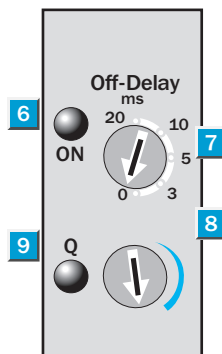

- 1 M5 threaded mounting hole, 5.5 mm deep
- 2 Light spot direction
- 3 Centre of optical axis
- 4 See dimensional drawing for lens
- 5 M12 plug (rotatable)
- 6 Operating indicator
- 7 Time delay selector switch
- 8 Sensitivity adjustment
- 9 Output indicator

Connection type

All types

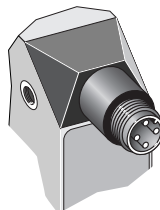

5-pin, M12

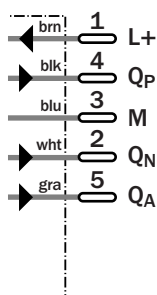

See chapter Accessories

Connectors

Mounting systems

Lenses

Fibre-optic cable

Luminescence scale

Technical data		LUT3-	810	820	850	890	851	852	853			
Scanning distance¹⁾/light spot sizes	10 mm/Ø 2 x 6 mm											
	20 mm/Ø 3 x 9 mm											
	50 mm/Ø 5 x 15 mm											
	90 mm/Ø 8 x 20 mm											
Light spot direction	Longitudinal											
Light source²⁾, light type	UV light source											
Wavelength	385 nm											
Receiver filter	OG 570											
	RG 610											
	RG 665											
Supply voltage V_S	12 ... 30 V DC ³⁾											
Ripple⁴⁾	max. 2 V											
Current consumption⁵⁾	60 mA											
Switching outputs	Light-switching											
	PNP: HIGH = V_S - <3 V / LOW = 0 V											
	NPN: HIGH = V_S / LOW = <2 V											
Output current I_A max.	100 mA											
Response time⁶⁾	0.3 ms											
Switching frequency⁷⁾	1.5 kHz											
Time delay (deactivation delay)	3 ms, 5 ms, 10 ms, 20 ms, adjustable											
Analogue output Q_A	0.5 ... 10 mA											
Connection type	Plug											
VDE protection class⁸⁾	□											
Circuit protection⁹⁾	A, B, C											
Enclosure rating	IP 67											
Ambient temperature	Operation -10 °C ... +55 °C											
	Storage -25 °C ... +75 °C											
Shock load	To IEC 68											
Weight	400 g											
Housing material	Die-cast metal											

¹⁾ From front edge of lens

²⁾ Average service life 100,000 h at $T_A = +25$ °C

³⁾ Limit values

⁴⁾ May not exceed or fall short of V_S tolerances

⁵⁾ Without load

⁶⁾ Signal transit time with resistive load

⁷⁾ With light/dark ratio 1:1

⁸⁾ Reference voltage 50 V DC

⁹⁾ A = V_S connections reverse-polarity protected

B = Outputs Q_P and Q_N short-circuit protected

C = Interference pulse suppression

Scanning distance

- 1 Scanning distance 10 mm
- 2 Scanning distance 20 mm
- 3 Scanning distance 50 mm
- 4 Scanning distance 90 mm

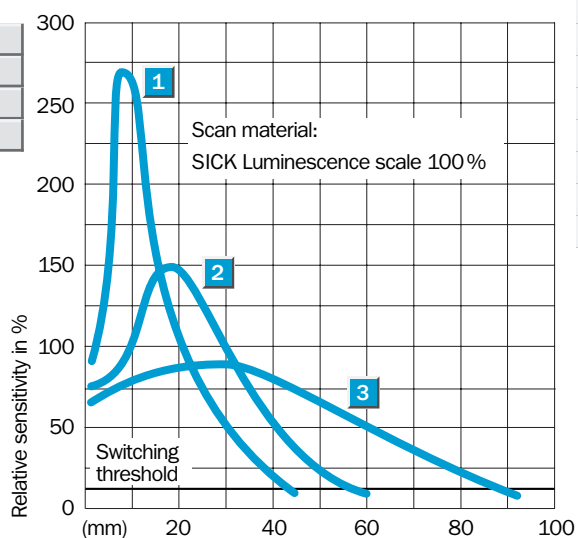

Order Information

Type	Order no.
LUT3-810	1 012 867
LUT3-820	1 012 868
LUT3-850	1 012 869
LUT3-890	1 014 058
LUT3-851	1 012 870
LUT3-852	1 012 871
LUT3-853	1 012 872

	Scanning distance 10 ... 90 mm
Luminescence scanners	

- UV semi-conductor light source
- No lamp replacement
- Scanning distance selectable by using interchangeable lenses
- Fibre-optic cable connection
- Analogue output
- Additional optical filter

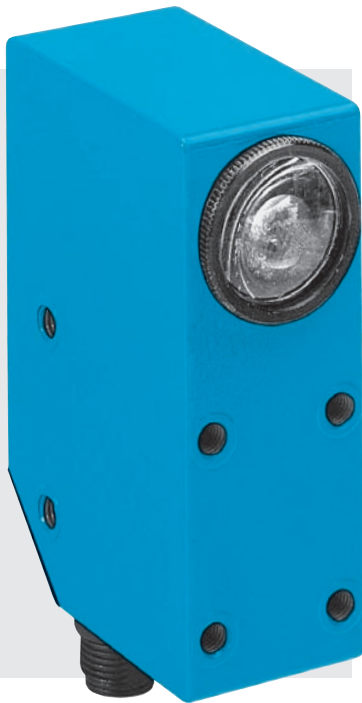

Dimensional drawing

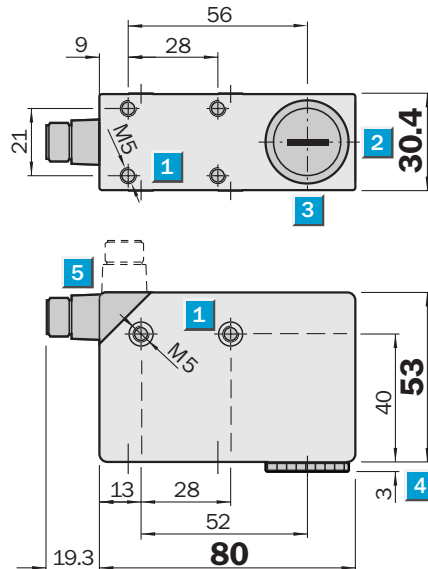

LUT3-910	LUT3-920
LUT3-950	LUT3-951
LUT3-952	LUT3-953

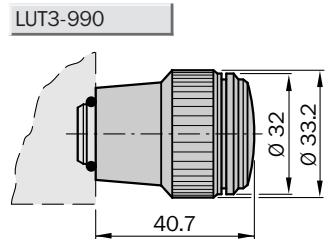
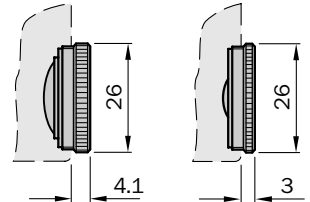

Adjustments possible

All types

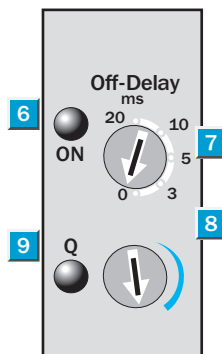

- 1 M5 threaded mounting hole, 5.5 mm deep
- 2 Light spot direction
- 3 Centre of optical axis
- 4 See dimensional drawing for lens
- 5 M12 plug (rotatable)
- 6 Operating indicator
- 7 Time delay selector switch
- 8 Sensitivity adjustment
- 9 Output indicator

Connection type

All types

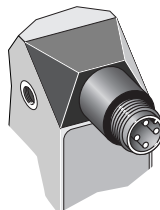

5-pin, M12

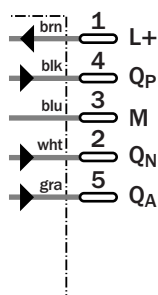

See chapter Accessories

- Connectors
- Mounting systems
- Lenses
- Fibre-optic cable
- Luminescence scale

Technical data		LUT3-	910	920	950	990	951	952	953			
Scanning distance¹⁾/light spot sizes	10 mm/Ø 2 x 6 mm											
	20 mm/Ø 3 x 9 mm											
	50 mm/Ø 5 x 15 mm											
	90 mm/Ø 8 x 20 mm											
Larger scanning distances on request												
Light spot direction	Longitudinal											
Light source²⁾, light type	UV light source											
Wavelength	370 nm											
Receiver filter	OG 570											
	RG 610											
	RG 665											
Supply voltage V_S	12 ... 30 V DC ³⁾											
Ripple⁴⁾	max. 2 V											
Current consumption⁵⁾	60 mA											
Switching outputs	Light-switching											
	PNP: HIGH = $V_S - <3$ V / LOW = 0 V											
	NPN: HIGH = V_S / LOW = <2 V											
Output current I_A max.	100 mA											
Response time⁶⁾	0.3 ms											
Switching frequency⁷⁾	1.5 kHz											
Time delay (deactivation delay)	3 ms, 5 ms, 10 ms, 20 ms, adjustable											
Analogue output Q_A	0.5 ... 10 mA											
Connection type	Plug											
VDE protection class⁸⁾	□											
Circuit protection⁹⁾	A, B, C											
Enclosure rating	IP 67											
Ambient temperature	Operation -10 °C ... +55 °C											
	Storage -25 °C ... +75 °C											
Shock load	To IEC 68											
Weight	400 g											
Housing material	Die-cast metal											

¹⁾ From front edge of lens

²⁾ Average service life 100,000 h at $T_A = +25$ °C

³⁾ Limit values

⁴⁾ May not exceed or fall short of V_S tolerances

⁵⁾ Without load

⁶⁾ Signal transit time with resistive load

⁷⁾ With light/dark ratio 1:1

⁸⁾ Reference voltage 50 V DC

⁹⁾ A = V_S connections reverse-polarity protected

B = Outputs Q_P and Q_N short-circuit protected

C = Interference pulse suppression

Scanning distance

- 1 Scanning distance 10 mm
- 2 Scanning distance 20 mm
- 3 Scanning distance 50 mm
- 4 Scanning distance 90 mm

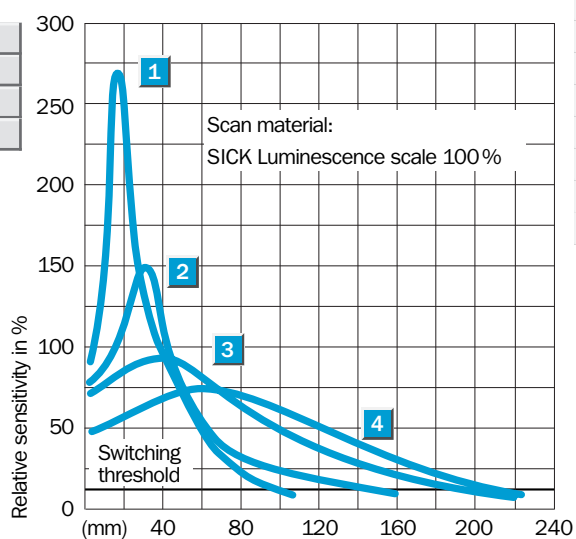

Order information

Type	Order no.
LUT3-910	1 019 285
LUT3-920	1 019 286
LUT3-950	1 019 287
LUT3-990	1 019 291
LUT3-951	1 019 288
LUT3-952	1 019 289
LUT3-953	1 019 290